



9

**Willow Oak  
(Quercus phellos)**

Over 20m. East America. Long narrow willow-like leaves turning orange and yellow in autumn



14

**Pyrenean Oak  
(Quercus pyrenaica)**

Native to southwestern Europe and northwestern Africa. Slow growing to 20m



1

**Holm Oak  
(Quercus ilex)**

Over 20m. Europe - Leathery, glossy dark green leaves. Evergreen



6

**Shingle Oak  
(Quercus imbricaria)**

Up to 20m. East America. Narrow, oblong, shining dark green leaves with rich autumn colour



10

**Nuttall's Oak  
(Quercus texana)**

A fast growing deciduous oak native to south-central USA. Grows 25m tall. Dark brown bark. Leaves with sharp pointed lobes



11

**Hungarian or Italian Oak  
(Quercus frainetto)**

Grows 38m tall by 66m broad with a possible trunk girth of nearly 2m. 6-8in long leaves



3

**Scarlet Oak  
(Quercus coccinea)**

North eastern America. Up to 30m. Bright green medium sized leaves with deep lobes. Bright red scarlet foliage in Autumn



13

**Macedonian Oak  
(Quercus trojana)**

South European species 20-30m when fully grown



8

**Common Oak  
'Atropurpurea'  
(Quercus robur)**

Purple leaved version of the common oak



12

**Butt Oak or Mossycap Oak  
(Quercus macrocarpa)**

Grows up to 30m. Slow growing - a foot per year. Leaves 3 - 6 inches long



4

**Texan Schumard Oak  
(Quercus buckleyi)**

Brilliant glossy green 7-9 lobe leaves. Good autumn colour



5

**Chestnut-leaved Oak  
(Quercus castanaefolia)**

A magnificent large oak from the eastern Caucasus. Narrowly ovate or oblong, margined with coarse triangular dark glossy green leaves



2

**Yellow Chestnut Oak  
(Quercus muehlenbergii)**

East America. Up to 20m. Yellowish green foliage and attractive autumn colours. Said to tolerate alkaline soils



7

**Red Oak  
(Quercus rubra)**

Over 20m. N.E.America. Fast growing with a broad head. Large oval leaves turning red in autumn



# COMMUNITY WOOD (Roy's Wood)

This Community Wood (Roy's Wood) is dedicated to the memory of the late Councillor Roy Hood who lived and worked in the village all his life and served on Loose Parish Council for over 40 years. He was passionate about Loose and its trees and worked tirelessly to protect its natural habitats. The fourteen oak trees (all different varieties) you see were donated by the Kent Men of the Trees and the diagram and illustrations detail each tree.

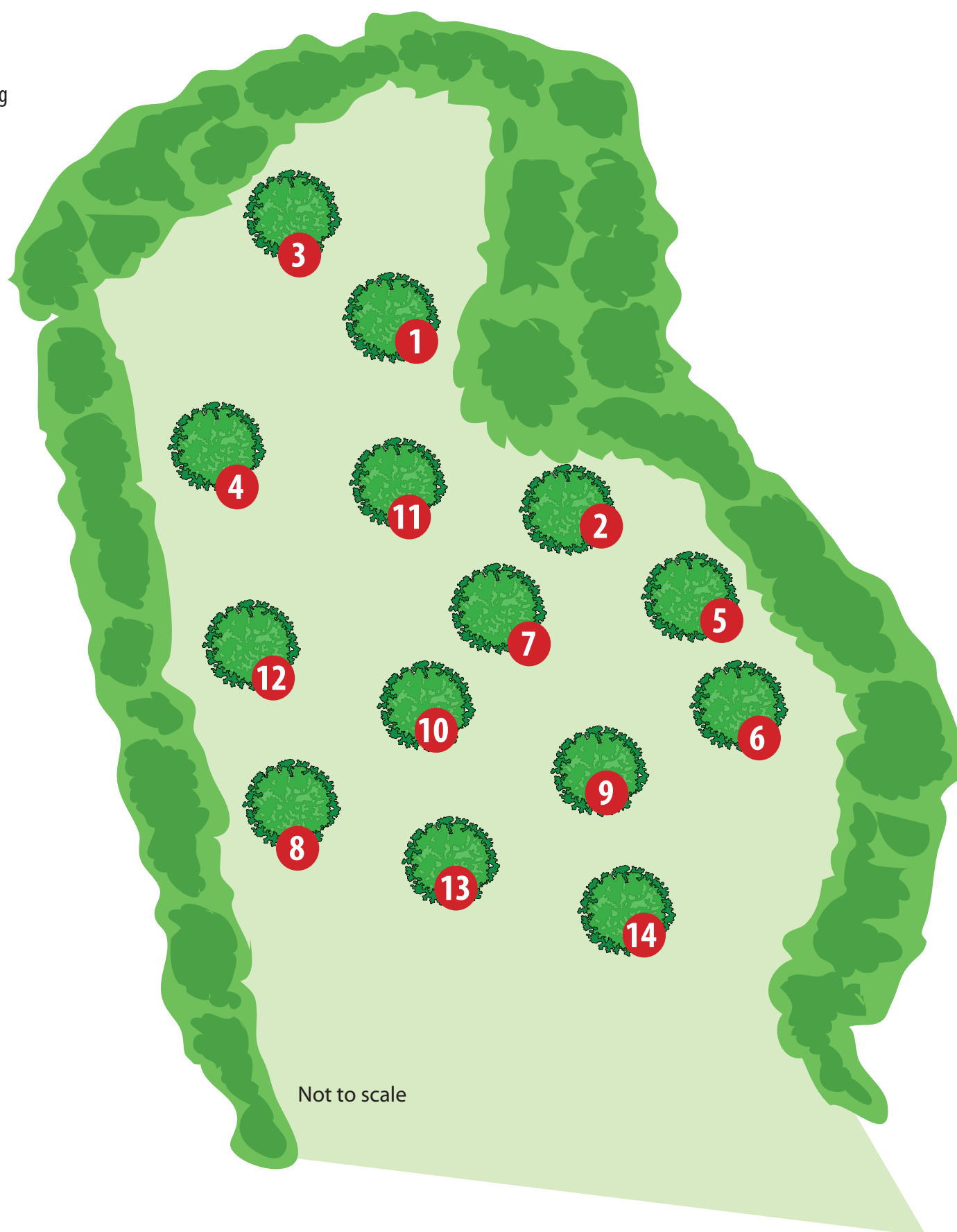

Not to scale